

SOLDER TYPE D-SUB CONNECTOR

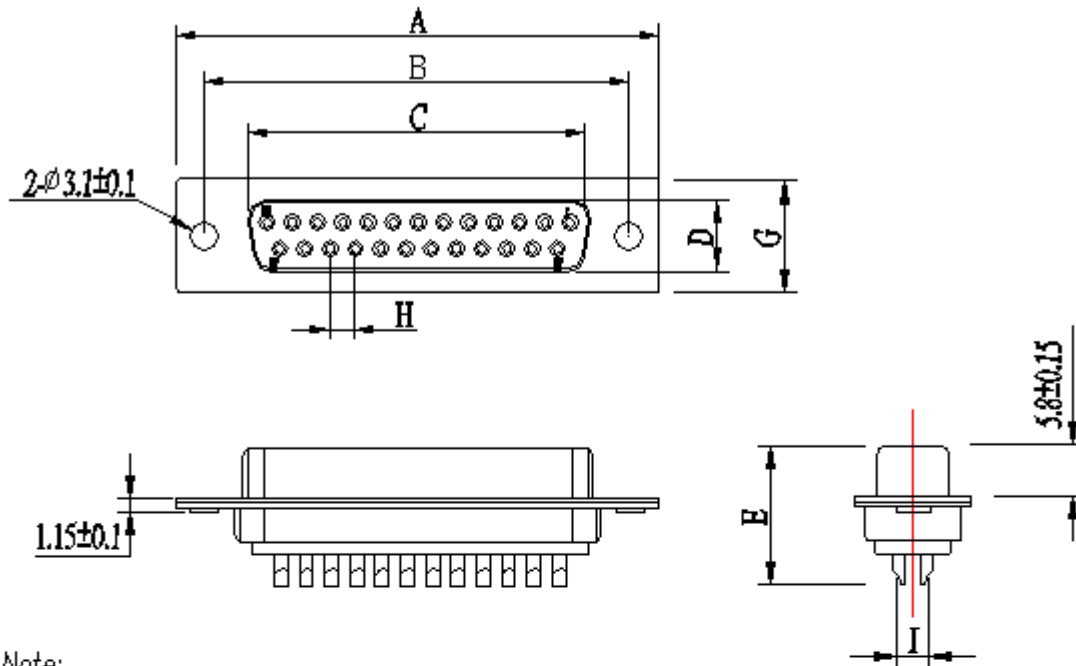

Note:

1. Material:

- 1.1 Insulator: High temperature thermoplastic with g.f, UL94v-0
- 1.2 Contact: Copper alloy, $t=0.20\text{mm}$
- 1.3 Shell: Spcc, $t=0.30\text{mm}$

2. Specification:

- 2.1 Current rating: 1 A Max.
- 2.2 Dielectric withstanding voltage: 750 V(ac) for 1, min.
- 2.3 Contact resistance: 30 m Ω Max.
- 2.4 Insulation resistance: 1000 M Ω Min.
- 2.5 Total mating force: 7.0 Kgf Max.
- 2.6 Total unmating force: 1.5 Kgf Min.
- 2.7 Temperature range: $-55^{\circ}\text{C} \sim 85^{\circ}\text{C}$

PART NO	A ± 0.25	B ± 0.20	C ± 0.20	D ± 0.20	E ± 0.30	G ± 0.25	H ± 0.05	I ± 0.10
2200-009S	30.81	24.99	16.33	7.9	15.0	12.55	2.77	2.84
2200-015S	39.25	33.32	24.66	7.9	15.0	12.55	2.77	2.84
2200-019S	44.80	38.86	30.0	7.9	15.0	12.55	2.77	2.84
2200-023S	50.30	44.3	35.3	7.9	15.0	12.55	2.77	2.84
2200-025S	53.04	47.04	38.38	7.9	15.0	12.55	2.77	2.84
2200-037S	69.50	63.50	54.84	7.9	15.0	12.55	2.77	2.84